

StressVest Dedicated M4 Electric Training Rifle



NO CONSUMABLES



Instruction Manual

CONTENTS

AR-15 / M4 Rifle System	3
StressVest Dedicated M4 Electric Training Rifle	3
Core Features	3
Safety Instructions and Handling	4
Cautions	4
Warnings	4
Battery Installation	5
Battery Operation	5
Charging	5
Safety Selector	5
Loading and Unloading the Magazine	6
Sighting using Stressvest Quick Sight Camera	6
Enhanced Polymer Rear Back Up Sight	7
Enhanced Polymer Front Back Up Sight	7
Adjusting the MOE Collapsible Stock	7
StressVest Long Gun Laser Mount	8
How to Operate StressVest Long Gun Laser Mount	8
Sighting StressVest Long Gun Precision Laser	8
Replacing StressVest Long Gun Precision Laser Battery	9
Troubleshooting	9

AR-15 / M4 RIFLE SYSTEM

The M4 Carbine is the most current rendition in a lineage of rifles that began with the original AR-15 rifle. Conceived as a gas operated, magazine-fed, selective fire, shoulder-fired rifle, the M4 Rifle system and its variants are the most common rifles employed by the US military and their allies today. In addition to the AR-15's well known accuracy, reliability, and popular ergonomics, a key factor encouraging adoption by so many different countries is its modularity. This allows it to be configured according to the needs of the user.

STRESSVEST DEDICATED M4 ELECTRIC TRAINING RIFLE

The StressVest Dedicated M4 Electric Training Rifles are variations based on the M4/AR-15 platform. The RM4 EGR (Electric Recoil Gun) represents the continued evolution of the AEG (Automatic Electric Gun). With its new features set, the RM4 offers the shooter a degree of functional realism not present in previous generations of AEGs.

The SV Dedicated M4 Electric Training Rifle features a functional bolt release, and simulated recoil via the proprietary Kinetic Feedback System.

The SV Dedicated M4 Electric Training Rifle is a perfect training gun for the shooter who desires simulated felt recoil, more realistic firearm manipulation and the reliability of Electric Airsoft Guns.

CORE FEATURES

- Electric Recoil Gun System
- Realistic construction and field stripping.
- Semi Auto and Full Auto select fire modes.
- Integrated EP Series Flip-up Front and Rear Back-up Sights, Stock and Grip.
- CNC machined aluminum construction.
- Picatinny rail mounting system.
- 10.75" Length Barrel.
- 10" C4 Rail
- Simulated recoil.

SAFETY INSTRUCTIONS AND HANDLING

You should be fully familiar with the proper and safe handling of your airsoft gun. The basic principles of weapons safety require you to always apply the following rules when handling airsoft guns:

- Always treat an airsoft gun/weapon as if it were loaded.
- Always put the safety of an airsoft gun/weapon to "SAFE" so that there can be no risk of an unintentional discharge.
- Keep your finger off the trigger and outside the trigger guard until you are ready to shoot.
- Always keep the muzzle pointed in a safe direction.
- Always store your airsoft gun/weapon in a safe place.
- This airsoft gun/weapon along with its operating instructions may only be handed over to persons who have reached the age of 18 (or older) and who are fully familiar with the handling of it.
- Modifications and/or repairs to the airsoft gun/weapon should only be completed by authorized agencies or by a skilled gunsmith.

CAUTIONS

- You must be 18 years or older to purchase this airsoft gun.
- Any alteration or conversion done to this airsoft product that leads to a different classification of the airsoft gun/weapon in regards to the applicable firearms legislation may render it illegal. If these circumstances occur, the manufacturer's warranty becomes immediately null and void.

WARNINGS

- Observe safe firearm handling practices at all times. Failure to do so may result in serious bodily injury or death. Setcan and PTS is not responsible for injury, death or property damage resulting from faulty installation, misuse, illegal use, or modification of this product.
- PTS products feature design modification and/or material construction that renders them incompatible with real firearms.
- DO NOT attempt to install, modify, or otherwise adapt PTS products for use on real firearms, as damage to the weapon and/or serious personal injury may occur.
- DO NOT attempt to use any type of projectile with the StressVest Dedicated M4 Electric Training Rifle.
- DO NOT expose the battery to fire.
- DO NOT put the battery in a charger or equipment with wrong terminals connected.
- Avoid shorting the battery.
- DO NOT disassemble, incinerate, or short-circuit battery.
- DO NOT use a damaged battery.
- DO NOT use the device in high humidity.
- Avoid excessive physical shock or vibration.
- DO NOT disassemble or deform the battery.
- DO NOT immerse in water.
- Keep out of the reach of children.

BATTERY INSTALLATION

1. To access the battery compartment within the stock, depress both buttons on either side of the stock.
2. Keeping both buttons depressed, pull the buttpad away from the stock.
3. Once the compartment is open, insert the battery inside the stock.
4. Then attach the male plug from the ERG system into the female connector from the battery.
5. Once the battery is plugged in, re-attach the buttpad back into the stock.

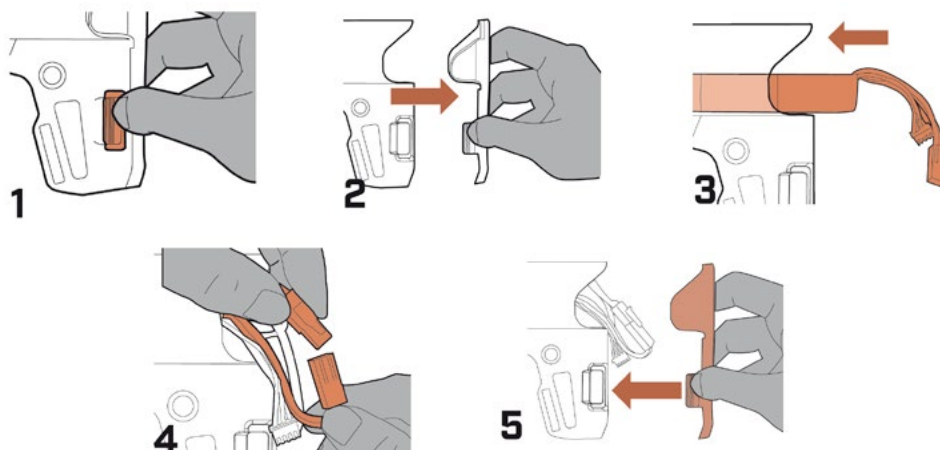

BATTERY OPERATION

Before the first use, the battery should be fully charged. Only use the battery under the specified temperature (-10°C-60°C).



CHARGING

- Only use the provided Tenergy Smart charger.
- Never use a modified or damaged charger.
- **DO NOT LEAVE THE BATTERY CHARGING FOR OVER 24 HOURS.**
- **NEVER LEAVE BATTERY UNATTENDED WHILE CHARGING.**

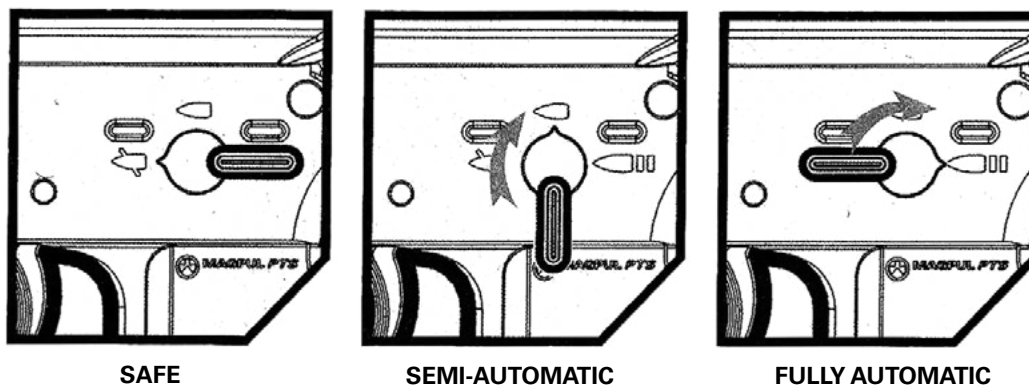

SAFETY SELECTOR

The StressVest Dedicated M4 Electric Training Rifle has three fire control settings: Safe (the gun cannot be fired), Semi-Automatic (the gun will fire once per trigger pull), and Fully Automatic (the gun will continue to fire while the trigger is depressed).

LOADING AND UNLOADING THE MAGAZINE

The StressVest ir M4 Electric Training Rifle includes a proprietary EGR PMAG. Insert the magazine release button on the right side of the RM4 releases the magazine which can then be removed from the gun.

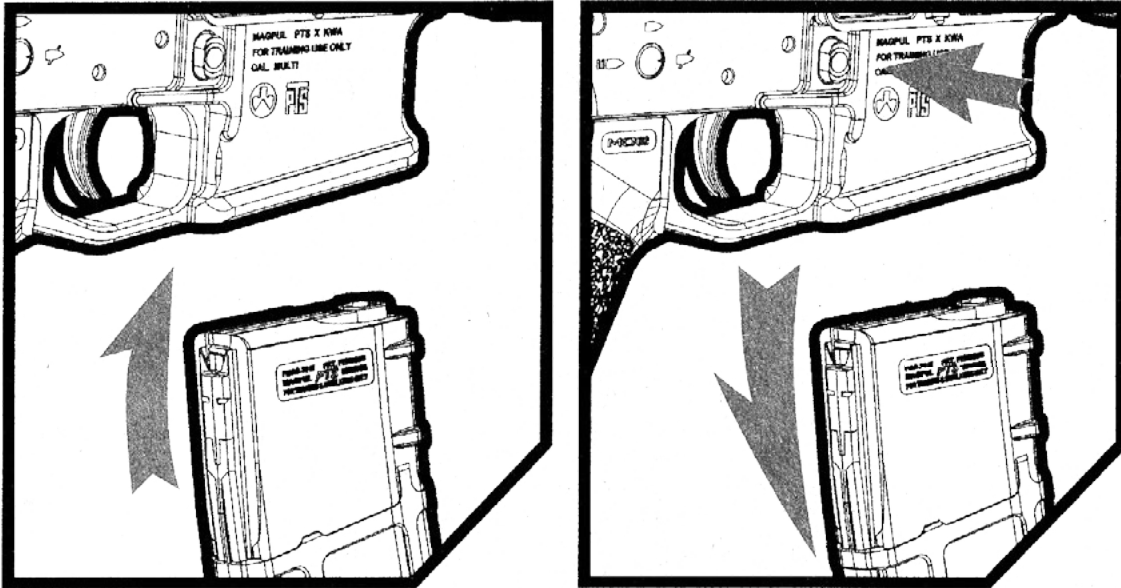

SIGHTING USING STRESSVEST QUICK SIGHT CAMERA

The StressVest Quick Sight will allow you to sight any StressVest® training weapon or laser insert. The laser is infrared (IR) so you cannot see it with the naked eye. The Quick Sight uses a USB camera that is capable of seeing the IR laser to track and display where the laser is striking on a target.



Download the StressVest® Quick Sight Software on the StressVest® Support Website

Ensure that your computer has internet access. Type in <http://stressvest.com/support/> on your web browser and log in using:

username: **support_cmr**
password: **svcustomer1**

Once logged in, click SOFTWARE in the sidebar and choose QUICK SIGHT. On the top right corner, click the link "click here to download Software" and download the installer. Follow the instructions on the Support website to install the software.

ENHANCED POLYMER REAR BACK UP SIGHT

1. To engage the EPBUIS Rear Sight upright, simply lift the sight by the textural plains on the sides to the ready position.
2. To adjust to the wind, rotate the adjustment dial that can be found on the right side of the sight accordingly.

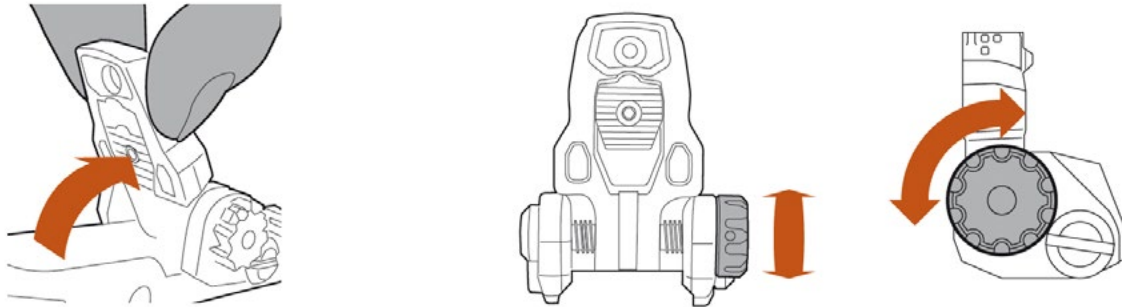

ENHANCED POLYMER FRONT BACK UP SIGHT

1. To engage the EPBUIS Front Sight upright, simply lift the sight by the textural plains on the sides to the ready position.
2. The front sight features the ability to adjust the sight post according to the elevation. Rotate the dial clockwise to raise and counter-clockwise to depress the post.

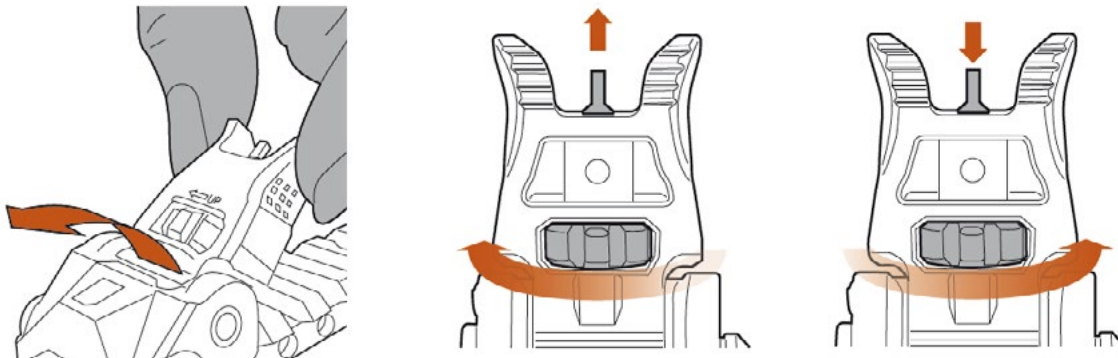

ADJUSTING THE MOE COLLAPSIBLE STOCK

1. To enable the stock to be adjusted, depress the Stock Extension Lever at the underbelly of the stock.
2. To enable the stock to be adjusted, depress the Stock Extension Lever at the underbelly of the stock.

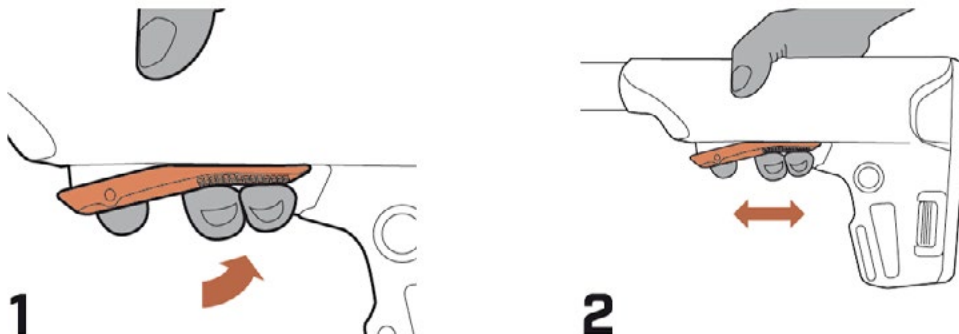

STRESSVEST LONG GUN LASER MOUNT

StressVest Long Gun Laser Mount is mounted on the flash suppressor. The StressVest Long Gun Laser Mount will emit an eye-safe ir laser pulse that will activate the StressVest every time the trigger is pulled.

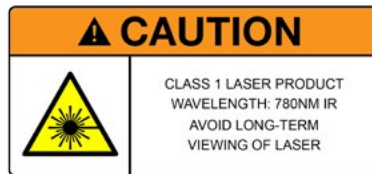

THIS PRODUCT COMPLIES WITH
US FDA CDRH 21CFR
SUBCHAPTER J PARTS 1040.10
AND 1040.11

HOW TO OPERATE STRESSVEST LONG GUN LASER MOUNT

1. To power on, press the Power button (D). The red Status Light (C) will flash once.
2. Check the sighting of the laser by shooting on a target. If required, adjust the sighting by following the sighting instructions below.
3. The Status Light (C) will flash every time the laser activates.
4. To power off, press and hold the Power button (D) until the Status Light turns on and then release the Power button (D).

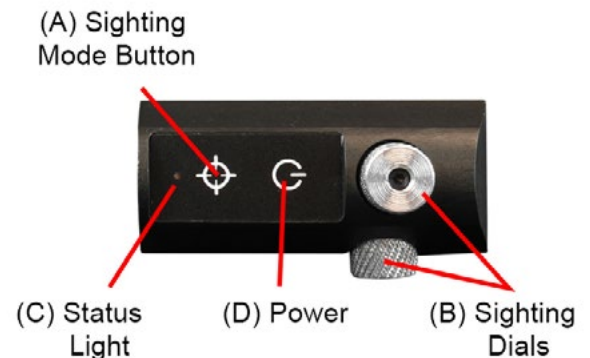

SIGHTING STRESSVEST LONG GUN PRECISION LASER

1. Power on the laser by pressing the Power button (D).
2. Press Sighting Mode Button (A), Status Light (C) will flash when on indicating laser is in sighting mode. When in sighting mode, the laser will pulse every one second.
3. Check sighting by using Quick Sight Camera (see page 6).
4. Adjust the horizontal/vertical sight alignment as necessary by turning Sighting Dials (B).
5. Once sighted in, tighten the Dial Locks completely with the hex key (hold Sighting Dial (B) while tightening).
6. Press Sighting Mode Button (A) to turn the Status Light (C) off.
7. StressVest Long Gun Laser Mount is ready for use.

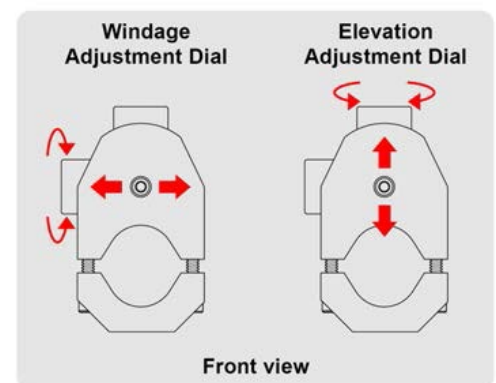

REPLACING STRESSVEST LONG GUN PRECISION LASER BATTERY

IMPORTANT: Make sure to turn off StressVest Long Gun Laser Mount when not in use. Battery life will be significantly less if left on. It is recommend to replace the battery every six months for optimal performance.

NOTE: The battery **SHOULD** be replaced if the laser fails to activate the StressVest® over long distance shots OR Status Light (C) appears dim.

1. Remove the laser mount from the flash suppressor by lossening the four screws on the bottom of the laser.
2. On the back of the laser, use a coin (or flat blade screwdriver) to unscrew End Cap.
3. Remove old battery and discard.
4. Insert one new CR123A battery, flat side first as illustrated.
5. Put a little dab of Vibra Tite VC-3 on the threads of battery cap to prevent loosening over time.
6. Thread End Cap back on and tighten with a coin (or flat blade screwdriver) snugly.

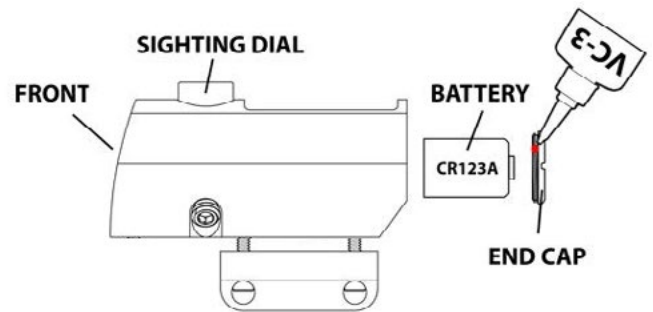

Note: Always ensure that the battery cap is tight. Laser may fail to activate if battery cap is loose.

TROUBLESHOOTING

If laser fails to activate try the following:

1. Verify that the battery cap is tight.
2. Replace the batteries.
3. If the laser still does not function, please contact StressVest®.

Note: You can test the laser with a StressVest® on vibrate by simply tapping the laser insert with a metal object.

Setcan Corporation

1080 Kingsbury Avenue
Winnipeg, Manitoba, Canada
R2P 1W5

Ph. 204-336-0011

Fax: 204-586-2049

Email: info@setcan.com

Web: www.setcan.com